

MARICOPA COUNTY
OFFICIAL PARCEL MAP
STATE OF ARIZONA

PT. SECTION 28 T02N R02W

MAP ID * 830 - 28 - 04 - 04

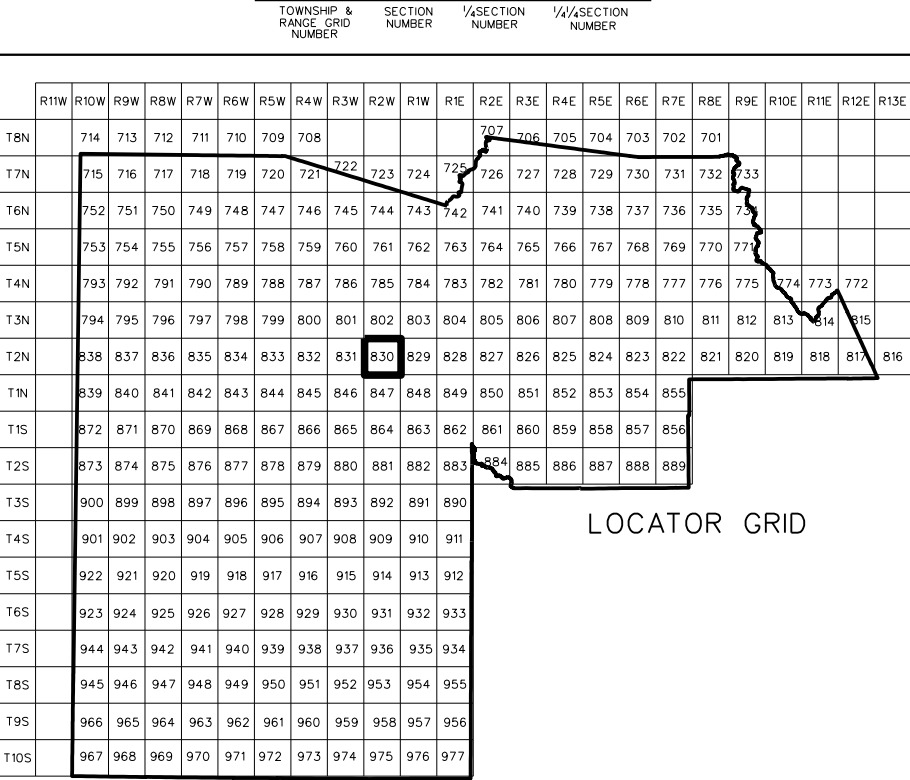

SECTION

06	05	04	03	02	01
07	08	09	10	11	12
18	17	16	15	14	13
19	20	21	22	23	24
30	29	28	27	26	25
31	32	33	34	35	36

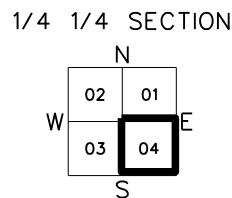
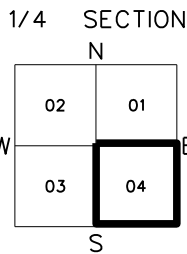

ASSESSOR BOOKS & MAPS WITHIN THIS AREA

BOOK: 502 MAP: 30
BOOK: 502 MAP: 32
BOOK: 502 MAP: 64

SUBDIVISIONS

LITCHFIELD FARMS 2
MCR 587-28, 2003 SUB
LITCHFIELD FARMS
MCR 587-29, 2003 SUB
LITCHFIELD FARMS 2 LOT 1 THRU 17 REPLAT
MCR 680-47, 2005 SUB

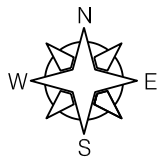

Maricopa County
Assessor G.I.S.

SCALE: 1" = 100'

09-09-2009

MARICOPA COUNTY ASSESSOR'S OFFICE
301 W. JEFFERSON ST.
PHOENIX, AZ 85003
www.maricopa.gov/assessor

LEGEND:

- Subdivision Boundary Line
- Subdivision Boundary Corner
- Street Centerline
- Street Centerline Marker
- Section Corner Marker
- Indicates change in original lot boundary
- Parcel Boundary Line
- Parcel Split Line
- Parcel Number
- Parcel Boundary Tie-In

Disclaimer - Indemnification

Requester/Purchaser understands and agrees that Maricopa County does not guarantee the accuracy of the data and information requested and hereby expressly disclaims any responsibility for the truth, lack of truth, validity, invalidity, accuracy, inaccuracy of any said data and information. The parcel lines on maps are for illustration purposes only and are not intended to be used as a survey product.

