

**MARICOPA COUNTY**  
STATE OF ARIZONA

PT. SECTION 19 T01N R07E

**855 - 19 - 02 - 01**

TOWNSHIP & RANGE SECTION 1/4 SECTION 1/4 1/4 SECTION

714	713	712	711	710	709	708	707	706	705	704	703	702	701
715	716	717	718	719	720	721	722	723	724	725	726	727	728
752	751	750	749	748	747	746	745	744	743	742	741	740	739
753	754	755	756	757	758	759	760	761	762	763	764	765	766
793	792	791	790	789	788	787	786	785	784	783	782	781	780
794	795	796	797	798	799	800	801	802	803	804	805	806	807
838	837	836	835	834	833	832	831	830	829	828	827	826	825
839	840	841	842	843	844	845	846	847	848	849	850	851	852
872	871	870	869	868	867	866	865	864	863	862	861	860	859
873	874	875	876	877	878	879	880	881	882	883	884	885	886
900	899	898	897	896	895	894	893	892	891	890			
901	902	903	904	905	906	907	908	909	910	911			
922	921	920	919	918	917	916	915	914	913	912			
923	924	925	926	927	928	929	930	931	932	933			
944	943	942	941	940	939	938	937	936	935	934			
945	946	947	948	949	950	951	952	953	954	955			
964	965	966	967	968	969	970	971	972	973	974			
965	968	969	970	971	972	973	974	975	976	977			

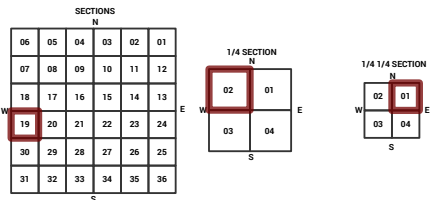

Parcels updated within this map

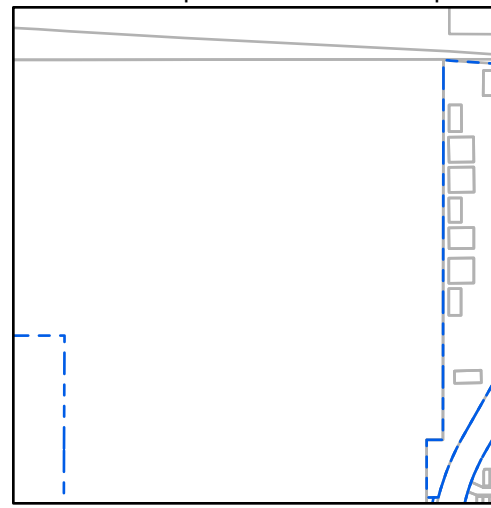

MARICOPA COUNTY  
ASSESSOR'S OFFICE  
301 W. Jefferson Street  
Phoenix, AZ 85003



**LEGEND:** Tax Parcels (red outline), Sections (dotted outline), Subdivisions (dashed outline), Lots (white fill), Section Corners (circle with cross), Centerlines (dashed line)

**Disclaimer - Indemnification**  
CAUTION! USERS SHOULD INDEPENDENTLY RESEARCH AND VERIFY INFORMATION WITHIN THIS DATASET OR MAP BEFORE RELYING ON IT.

The Assessor's Office has compiled information within this dataset or map that it uses to identify, classify, and value real and personal property. Please contact the Assessor's Office at 602 506-3406 if you believe any information is incomplete, out of date, or incorrect so that appropriate corrections can be addressed. Please note that a statutory process is also available to correct errors pursuant to Arizona Revised Statutes 42-16254.

The Assessor does not guarantee that any information contained within this dataset or map is accurate, complete or current. In many instances, the Assessor has gathered information from independent sources and made it available within this dataset or map, and the original information may have contained errors and omissions. Errors and omissions may have occurred in the process of gathering, interpreting, and reporting the information. Information within this dataset or map is not updated "real time." In addition, Users are cautioned that the process used within this dataset or map to illustrate the boundaries of adjacent parcels is not always consistent with the recorded documents for such parcels. The parcel boundaries depicted within this dataset or maps are for illustrative purposes only, and the exact relationship of adjacent parcels should be independently researched and verified. The information provided within this dataset or map is not the equivalent of a title report or a real estate survey. Users should independently research, investigate, and verify all information before relying on it or using it in the preparation of legal documents.

Map Reprint Date: 2/27/2026

**SUNRISE RANCH 1 LOT**  
**48-51, 56-62, 65-67**  
**MCR: 045-10**

E UNIVERSITY DR 1667.292'

9\* 218-10-004A

1915.63' T01N R07E Sec. 18  
1556.06' T01N R07E Sec. 19

1470'

218-10-006

218-14-039

218-14-017

218-14-018

218-14-019

218-14-020

218-14-021

218-14-022

218-14-023

218-14-024

218-14-040

218-17-065

218-17-064

218-17-067

218-17-068

218-13-006N

1284.91'

**SUNVALLEY OFFICE PARK**  
**MCR: 589-44**

**SUNRISE PROPERTIES UNIT 1 AMD 1**  
**MCR: 224-40**

**SANCTUARY ON SUNVALLEY**  
**MCR: 904-13**

218-17-064

218-17-067

218-17-068

218-17-069

218-17-070

218-17-071

218-17-072

218-17-073

218-17-074

218-17-075

218-17-076

218-17-077

218-17-078

218-17-079

218-17-080

218-17-081

218-17-082

218-17-083

218-17-084

218-17-085

218-17-086

218-17-087

218-17-088

218-17-089

218-17-090

218-17-091

218-17-092

218-17-093

218-17-094

218-17-095

218-17-096

218-17-097

218-17-098

218-17-099

218-17-100

218-17-101

218-17-102

218-17-103

218-17-104

218-17-105

218-17-106

218-17-107

218-17-108

218-17-109

218-17-110

218-17-111

218-17-112

218-17-113

218-17-114

218-17-115

218-17-116

218-17-117

218-17-118

218-17-119

218-17-120

218-17-121

218-17-122

218-17-123

218-17-124

218-17-125

218-17-126

218-17-127

218-17-128

218-17-129

218-17-130

218-17-131

218-17-132

218-17-133

218-17-134

218-17-135

218-17-136

218-17-137

218-17-138

218-17-139

218-17-140

218-17-141

218-17-142

218-17-143

218-17-144

218-17-145

218-17-146

218-17-147

218-17-148

218-17-149

218-17-150

218-17-151

218-17-152

218-17-153

218-17-154

218-17-155

218-17-156

218-17-157

218-17-158

218-17-159

218-17-160

218-17-161

218-17-162

218-17-163

218-17-164

218-17-165

218-17-166

218-17-167

218-17-168

218-17-169

218-17-170

218-17-171

218-17-172

218-17-173

218-17-174

218-17-175

218-17-176

218-17-177

218-17-178

218-17-179

218-17-180

218-17-181

218-17-182

218-17-183

218-17-184

218-17-185

218-17-186

218-17-187

218-17-188

218-17-189

218-17-190

218-17-191

218-17-192

218-17-193

218-17-194

218-17-195

218-17-196

218-17-197

218-17-198

218-17-199

218-17-200

218-17-201

218-17-202

218-17-203

218-17-204

218-17-205

218-17-206

218-17-207

218-17-208

218-17-209

218-17-210

218-17-211

218-17-212

218-17-213

218-17-214

218-17-215

218-17-216

218-17-217

218-17-218

218-17-219

218-17-220

218-17-221

218-17-222

218-17-223

218-17-224

218-17-225

218-17-226

</