

MARICOPA COUNTY

STATE OF ARIZONA

PT. SECTION 2 T01S R06E

857 - 02 - 01 - 02

TOWNSHIP & RANGE SECTION 1/4 SECTION 1/4 1/4 SECTION

714	713	712	711	710	709	708	707	706	705	704	703	702	701
715	716	717	718	719	720	721	722	723	724	725	726	727	728
753	754	755	756	757	758	759	760	761	762	763	764	765	766
793	792	791	790	789	788	787	786	785	784	783	782	781	780
838	837	836	835	834	833	832	831	830	829	828	827	826	825
873	874	875	876	877	878	879	880	881	882	883	884	885	886
918	919	920	921	922	923	924	925	926	927	928	929	930	931
963	964	965	966	967	968	969	970	971	972	973	974	975	976
1008	1009	1010	1011	1012	1013	1014	1015	1016	1017	1018	1019	1020	1021

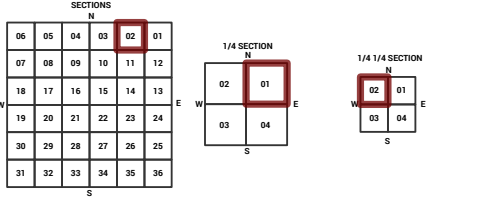

Parcels updated within this map

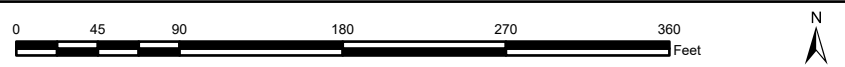
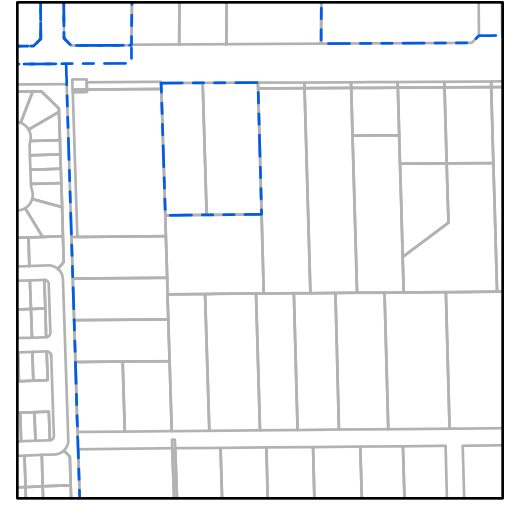

MARICOPA COUNTY
ASSESSOR'S OFFICE
301 W. Jefferson Street
Phoenix, AZ 85003

MARICOPA COUNTY
ASSESSOR'S OFFICE
<https://mcaassessor.maricopa.gov>

LEGEND: Tax Parcels (red outline), Sections (dashed blue outline), Subdivisions (dotted blue outline), Lots (thin red outline), Section Corners (circle with cross), Centerlines (dashed line)

Disclaimer - Indemnification
CAUTION! USERS SHOULD INDEPENDENTLY RESEARCH AND VERIFY INFORMATION WITHIN THIS DATASET OR MAP BEFORE RELYING ON IT.

The Assessor's Office has compiled information within this dataset or map that it uses to identify, classify, and value real and personal property. Please contact the Assessor's Office at 602 506-3406 if you believe any information is incomplete, out of date, or incorrect so that appropriate corrections can be addressed. Please note that a statutory process is also available to correct errors pursuant to Arizona Revised Statutes 42-16254.

The Assessor does not guarantee that any information contained within this dataset or map is accurate, complete or current. In many instances, the Assessor has gathered information from independent sources and made it available within this dataset or map, and the original information may have contained errors and omissions. Errors and omissions may have occurred in the process of gathering, interpreting, and reporting the information. Information within this dataset or map is not updated "real time." In addition, Users are cautioned that the process used within this dataset or map to illustrate the boundaries of adjacent parcels is not always consistent with the recorded documents for such parcels. The parcel boundaries depicted within this dataset or maps are for illustrative purposes only, and the exact relationship of adjacent parcels should be independently researched and verified. The information provided within this dataset or map is not the equivalent of a title report or a real estate survey. Users should independently research, investigate, and verify all information before relying on it or using it in the preparation of legal documents.

Map Reprint Date: 2/28/2026

