

MARICOPA COUNTY  
STATE OF ARIZONA

PT. SECTION 7 T02S R06E

888 - 07 - 02 - 01

TOWNSHIP & RANGE SECTION 1/4 SECTION 1/4 1/4 SECTION

714	713	712	711	710	709	708	707	706	705	704	703	702	701
715	716	717	718	719	720	721	722	723	724	725	726	727	728
753	754	755	756	757	758	759	760	761	762	763	764	765	766
793	792	791	790	789	788	787	786	785	784	783	782	781	780
829	828	827	826	825	824	823	822	821	820	819	818	817	816
859	858	857	856	855	854	853	852	851	850	849	848	847	846
882	881	880	879	878	877	876	875	874	873	872	871	870	869
899	898	897	896	895	894	893	892	891	890	889	888	887	886
901	902	903	904	905	906	907	908	909	910	911	912	913	914
922	921	920	919	918	917	916	915	914	913	912	911	910	909
923	924	925	926	927	928	929	930	931	932	933	934	935	936
944	943	942	941	940	939	938	937	936	935	934	933	932	931
945	946	947	948	949	950	951	952	953	954	955	956	957	958
964	965	966	967	968	969	970	971	972	973	974	975	976	977
967	968	969	970	971	972	973	974	975	976	977	978	979	980

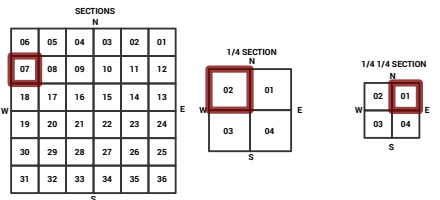

Parcels updated within this map

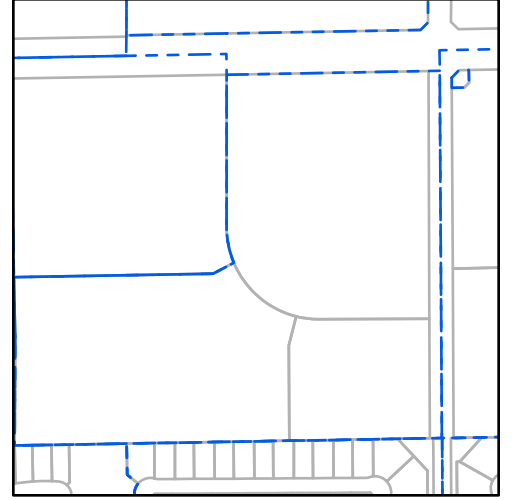

MARICOPA COUNTY  
ASSESSOR'S OFFICE  
301 W. Jefferson Street  
Phoenix, AZ 85003



**LEGEND:** Tax Parcels (red outline), Sections (dotted outline), Subdivisions (dashed outline), Lots (solid outline), Section Corners (circle with cross), Centerlines (dashed line)

**Disclaimer - Indemnification**  
CAUTION! USERS SHOULD INDEPENDENTLY RESEARCH AND VERIFY INFORMATION WITHIN THIS DATASET OR MAP BEFORE RELYING ON IT.

The Assessor's Office has compiled information within this dataset or map that it uses to identify, classify, and value real and personal property. Please contact the Assessor's Office at 602 506-3406 if you believe any information is incomplete, out of date, or incorrect so that appropriate corrections can be addressed. Please note that a statutory process is also available to correct errors pursuant to Arizona Revised Statutes 42-16254.

The Assessor does not guarantee that any information contained within this dataset or map is accurate, complete or current. In many instances, the Assessor has gathered information from independent sources and made it available within this dataset or map, and the original information may have contained errors and omissions. Errors and omissions may have occurred in the process of gathering, interpreting, and reporting the information. Information within this dataset or map is not updated "real time." In addition, Users are cautioned that the process used within this dataset or map to illustrate the boundaries of adjacent parcels is not always consistent with the recorded documents for such parcels. The parcel boundaries depicted within this dataset or maps are for illustrative purposes only, and the exact relationship of adjacent parcels should be independently researched and verified. The information provided within this dataset or map is not the equivalent of a title report or a real estate survey. Users should independently research, investigate, and verify all information before relying on it or using it in the preparation of legal documents.

Map Reprint Date: 3/1/2026

